

THE BABA BULLETIN

The Bay Area Bluegrass Association

5820 Misty Meadow, League City, TX 77573

September 2014

28 Years of Bluegrass

Volume 28, Issue 3



PRESIDENT'S MESSAGE:

For those of you that missed the festival you missed a good one. Our congratulations go to the winners of all the contests and to the best in the great state of Texas. We are really proud of you.

I'm not going to try to list everyone that helped out with the festival but thank you all for making it the smoothest festival we have ever had.

Thanks to all the bands you all did a great job.

Now let's finish off this year with great shows! This month features *Cypress Creek*, and opening the show is *Southern Style*. Following the featured band is *Out of the Blue*, a new "old" group of gents you will really love.

BABA needs your help. Just like everyone else we are being affected by the hard economic times. It has always been a balancing act to keep BABA going in the black but in recent months the balance hasn't been so good. The shows have been good, the jams have been good but the balance sheet has been out of balance.

Your membership and donations are what keeps BABA going. Help us keep BABA going. If you aren't a member, join. Ask your friends & family who enjoy bluegrass to join. Ask your employers if they have a donations program for non profit groups. Remember,, we are only as strong as our members. Donate what you can when you can. Keep on picking!

Rick Kirkland



INSIDE:

Anne's Notes
Last Month's show
Upcoming shows
Membership
Pick Your News
Websites
Fire on the Strings
Stringing You Along
Special Events
Bluegrass Venues
Monthly Jams
Festival Flyers
Bluegrass Radio
Thinkin' & Grinnin'
More cool stuff
Advertise here!!



Articles are opinions of the writers alone and do not imply agreement on the part of the Board of Directors or the Members.

*Anne's Notes***“I'm the Best Mandolin Player in This Walmart!”**

I had the honor and pleasure of being in Joe Carr's intermediate mandolin class for the workshops at Camp Bluegrass 2013. Joe has been in and around the bluegrass profession many years, puts together Camp Bluegrass each year (with a little help from his wife, Paula), and has written and produced instructional books and videos, including more than 30 videos for Mel Bay and Texas Music Video (from Mandolin Magazine).



While in his class that summer, we struggling mandolinists were taught pentatonic scales, fun tunes, and a “Joe Carr Tag” created especially for the mandolin. He was always very aware that we, as intermediates, know just enough to know how very little we know. In the evenings, all campers would be treated to faculty concerts, which included outstanding mandolin faculty members such as Steve Smith and Gerald Jones. During mixed jams in the evenings, we would be awestruck by the more advanced players of the mandolin. When someone in our section commented on our, um, lack of talent or slow progress and exasperation in playing, Joe paused in his teachings to comment on this observation:



After you go home from this camp, I want you to go over to your local Walmart. Go to the main office. Go in and pick up the mike for the store's p.a. system. Stand tall and proud and proclaim in your strongest, most sincere voice, “I am the best mandolin player in this Walmart!”

After a bit of chuckling, we all realized that this was, most likely, going to be a true statement, taking in, of course, that none of us was from Nashville. I'm pretty sure it would even be true for me, in spite of my slow progress on the instrument. In fact, I'm pretty sure than well over

GOT KIDS?
GRANDKIDS?
Electrified pals?
Come by the shop and see our **fine electric instruments and amps, too.**

Starter kits to professional grade. Check us out!

FULLER'S VINTAGE GUITAR

116 North Loop (610 @ Yale)
Houston, TX 77008
713-880-2188 www.fullersguitar.com

FOR ALL YOUR BLUEGRASS NEEDS

Acoustic Guitars
Vintage Kay Basses
Mandolins
Banjos
Dobros
Accessories



Bluegrass Night in League City



Saturday, Oct 18th 2014

Prairie Fire, Pet Rooster

Johnnie Arolfo Civic Center, 300 West Walker, League City Tx

Jam Sessions start @ 5:00 p.m., Stage shows @ 7:00 p.m.

Admission is free, but donations are welcomed.

No alcohol, but great music and family entertainment.

Details available at www.bayareabluegrass.org



Bay Area Bluegrass Association

Let's welcome a re-created 'Bluegrass Etc.' band to the B.A.B.A Stage, this Saturday September 20th. Eat your Wheaties, take a nap in the afternoon, add a multivitamin and plan to stay up late!

They don't start until the 9:00 PM slot at the regular September Show in League City, and you won't want to leave early and THEN find out what you missed!

Out of the Blue - Bluegrass, Gospel and Western Swing Music



The "Out of the Blue" band was originally formed during the summer of 2012 when Greg English, Ed Fryday, Jay Blocker and R. Lynn Holbrook wanted to form a group local to the NASA area. Unfortunately, work and family pressures caused the band to put things on hold during the Fall of 2012 and the group remained dormant until the early summer of 2014. At that point in time, Greg reached out to everyone for a gospel show at his church in Pasadena, TX and the group hit the ground running.

One important addition to the original roster was Randy Jones, a childhood friend of Jay Blocker in Florida, who recently moved to Texas City from Nashville (by way of New Orleans!). Randy brings a wealth of musical experience to the group and is proficient on fiddle, mandolin and guitar.

Today... the group consists of Greg English (banjo/guitar), Jay Blocker (guitar), Ed Fryday (bass), R. Lynn Holbrook (reso) and Randy Jones (fiddle/mando/guitar). On the set list, fans will find a mixture of traditional & modern bluegrass music, gospel, cowboy and western swing tunes ensuring there is something to please everyone in the audience.

Finally, the band name was chosen to imply the performance of music outside the bluegrass genre using instruments within the traditional form. We look forward to performing in and around the greater bay area of Houston!

FIRE ON THE STRINGS BANJO AND GUITAR COMPETITION RESULTS

Thanks to the contestants, to the winners, and to the Directors and Volunteers who put on the Fire on the Strings Bluegrass Festival every year.

Thanks most of all to our generous and committed sponsors, without whom there would be no festival at all, no matter how much talent is available and no matter how hard the Bluegrass Association members are willing to work.

Outstanding sponsors for the talent competition are **Mike Fuller** of Fuller's Vintage Guitars (www.fullersguitar.com) who donated the prize money for all of the competitions, **Mike Fuller and BABA for the Deering Banjo**, **Jeff Robertson** who hand-built and donated the custom Robertson acoustic guitar (<http://jeffrobertsonguitars.com>), and **Ed Fryday** of Space City Inspections (www.spacecityinspections.com) who donated the trophies for all of the competitions.

Additional thanks are in order to Lynn Holbrook for organizing and running two well organized contests, to the anonymous judges who evaluated the 'arrangement, execution, show value and overall impression of skill' for all of the musicians, and to the auditors who not only had to do the math, they all had to come up with the same numbers in order to finalize the winners lists! (you can tell that math scares me, right?)

The WINNERS: <mental drumroll please>

August 16, 2014 Texas State Banjo Competition

3rd Place: \$50 and a trophy

Garrett Ratliff from Cherokee, Texas

2nd Place: \$150 and a trophy

Hudson Doucette from Waller, Texas

1st Place: \$300, a trophy, a Deering banjo, and paid entry to the National Competition at Winfield representing the state of Texas

Jacob Sowell from Hempstead, Texas

August 16, 2014 Texas State Flat Picking Guitar Competition

3rd Place: \$50 and a trophy

Ryan O'Donnell from Fair Oaks Ranch, Texas

2nd Place: \$150 and a trophy

Garrett Ratliff from Cherokee, Texas

1st Place: \$300, a trophy, a custom Jeff Robertson dreadnaught guitar, and paid entry to the National Competition at Winfield representing the state of Texas

Joshua Bailey from Victoria, Texas

Do you work for Boeing? They have a matching funds program for qualifying donations (that's us at BABA!)

If you would like to change or add a new organization to receive BPAC funding, please log onto the BPAC match website through Total Access by clicking on "My Community Giving." There you will see the BPAC Gift Match tab, and you can direct where your allowance should be remitted. You have 30 days from the date of this letter to make any changes to your designation.

For more information, please contact the BPAC Manager, at bpac@boeing.com or 703-465-3232.

FREE



**Friday & Saturday October 17-18, 2014
Farmers Branch Texas Historical Park**

**Rhonda Vincent & The Rage © Seldom Scene
Gibson Brothers © Joe Mullins & Radio Ramblers
Kenny & Amanda Smith Band © Balsam Range
Rambling Rooks © Flatt Lonesome**

Free Admission, no ticket required

Join us for the **Friday night festival after-party**
with **Frank Solivan & Dirty Kitchen**
10:30pm at the **Night Hotel**
(Free for Night Hotel Guests)

Two days of great music, chili, and beautiful flowers under the Texas sky. Bring your blankets and lawn chairs.

Only 15 minutes from F Airport. **Discounted Festival Room Rates!** RV parking available.

Festival hours
Friday 4:30p - 10p
Saturday 10:30a - 10p.

Check our website at: BluegrassHeritage.org for more details about special deals on hotel rooms. Artists and schedule subject to change without notice.

Farmers Branch Historical Park
2540 Farmers Branch Ln
Farmers Branch, Texas 75234

BloominBluegrass.com
info@BloominBluegrass.com

Bluegrass Heritage Foundation
BluegrassHeritage.org

**FARMERS
BRANCH**

This event is brought to you by the City of Farmers Branch, Texas and the Bluegrass Heritage Foundation.

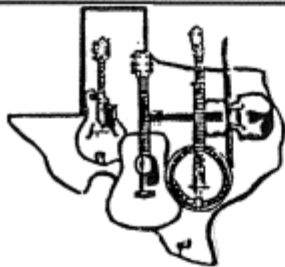

Spring Creek Bluegrass Club BLUEGRASS MUSIC WEEKEND

October 23 24, 25, 2014

At **COUSHATTE Recreation Ranch • Bellville, Texas**

- Lots of jamming • Shade Trees and Good Campsites • Food Vendors
- Arts & Crafts • No Pets in Concert or Vending Area • Proper Dress Required
- Rain or Shine Event - In case of bad weather the show will be moved inside •

Family Bluegrass Entertainment

Rich In Tradition-	Pine Hall, NC	(F-S)
The Saltgrass Band-	Lake Jackson, Tx	(F-S)
Jeff Brown/Still Lonesome-	Cedar Bluff, Va	(F-S)
Gaskills Bluegrass -	Edmond, Ok	(F-S)
Pet Rooster -	Lake Jackson, TX	(F)
Lonestar Bluegrass Band-	Sugar Land, Tx	(S)
Greer Family Band-	Burton, Tx	(T-F)
Buffalo Nickle-	Sugar Land, Tx	(T)
Texas Olde Tyme Bluegrass-	Magnolia, Tx	(T)
The Doucettes -	Waller, Tx	(T)

Sound by: **Mary Marshall** Nashville, AR
Emcee: **Buddy Brockett**

ADMISSION

Per person
Advance - 3 Day - \$40.00
 When Received by Oct. 15
3 Day - At Gate - \$45.00
Thursday \$10.00
Friday \$20.00
Saturday \$20.00
 (Tax included)
 Children Under 14 FREE

MUSIC STARTS

Thur. 6:00 pm • Fri. 1:00 PM • Sat. 1:00 pm
 Open Stage 10:00am Saturday

OVER NIGHT CAMPING

Most w/Water/Elect/Sewer
\$20. - a day - 30 / 50 amp
NO Reservations
 \$10. Rough Camping
 \$5. Per day - Campers dropped off
Camping fees collected at the gate only.

MOTELS IN AREA

**** Ask for Bluegrass Rates**

- ** Holiday Inn Exp - Sealy (979) 877-0700
- ** Super 8 - Sealy (979) 885-2121

FOR TICKETS & INFORMATION

Spring Creek Bluegrass Club
 % Buddy or Carolyn Brockett
 PO Box 1294 - Bellville, TX 77418
(979) 877-9526 / 877-9865
Coushatte Ranch: (979) 865-5897

e-mail: bluegrass221@peoplepc.com

Not responsible for accidents or weather

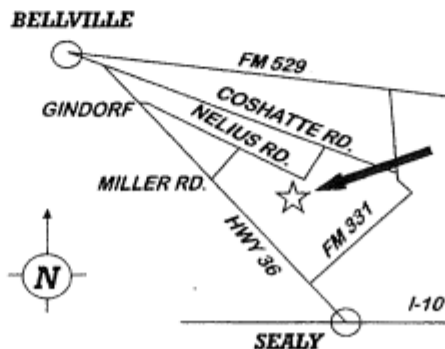
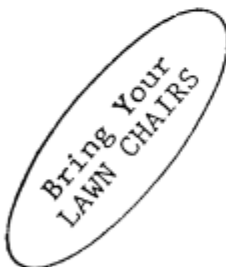

**Coushatte
 Recreation Ranch**
 On Nelius Road
 between
 Sealy and Bellville

Absolutely **NO Alcoholic Beverages** Allowed • Violators Will be Forced to Leave • **NO Refunds**

WHAT WOULD WE DO WITHOUT OUR SPONSORS? NOTHING! PLEASE SUBSIDIZE THEM WHEN YOU ARE ABLE, AND BE SURE TO THANK THEM FOR SUPPORTING THE BLUEGRASS MUSIC THAT YOU LOVE!

Texas Air Services, Inc
281-337-7763
www.texasairservices.com



"A trusted partner in Aviation & Engineering Innovations"



SPACE CITY INSPECTIONS, LLC
Professional Real Estate Inspectors
TREC Lic. #6932 & 6971
www.spacecityinspections.com

PROSPERITY BANK
Prosperity Bank Corporate Offices
1301 North Meacham
El Campo, Texas 77437
979-578-8181
contactus@prosperitybanktx.com

COMMERCIAL & RESIDENTIAL SERVICE



281-488-2244
Rick Kirkland 5820 Misty Meadow
crk5820@msn.com League City, TX. 77573

Hayden Associates



Residential
Real Estate
Appraisals

281.353.3531

Ron & Anne Hayden

Sey Tec CW Aerotech Services

Human Owned Small Business
Ron Childs
General Manager
807 Bud Jones Drive North Richland Hills, TX 76180
rchild@seystec.com www.seystec.com
952-9401-2400 AS-9108 FAA-AI 815A



Rates & Reservations
sndpr325@aol.com

Sand Piper RV Park
Seawall Blvd & Ferry Road
Galveston Island, Texas 77550
409-765-9431 or 409-765-9439
http://sandpiperresort.com/

Bayview Christian Center

Sunday 10am - Wednesday Home Groups

Pastors: F. "Chico" & Anna Michael
Church Ofc: 281-559-3214

Meeting: 2905 Lenox St Bacliff, TX
Mailing: POB 447 Kemah, TX 77565

Email: Bayviewcc@comcast.net
Web: www.bayviewcc.org



Memorial Lutheran Church

Wayne Clement / Pastor
2021 29th Street N, Texas City, Texas
77590 Ph: (409) 945-4052
Web Site: <http://www.mlctc.org/>
mlctc@yahoo.com/pastor@mlctc.org

Christopher
Episcopal Church
"We are a church of peace and love."
Established in 1908
409-945-7500
409-945-7500
409-945-7500
Come join us!
SUNDAY WORSHIP 10:00 AM with coffee and prayer
at 2021 29th Street N, Texas City, TX 77590



G. L. Copelin, Inc.

Carland L. Copelin PE Code Inspector
TREC Windstorm - IBC Energy - URC Structural

P.O. Box 2187
391 21st Street North
Texas City, TX 77581

Phone: 409-945-1559
Fax: 409-945-8183
Cell: 409-945-0134
Email: glcopelin@aol.com

Harrison Electropolishing LP



Paul TC Jers Jr.
President
281-252-1118
281-252-0800
281-252-0800
281-252-1818
jers@heritagebank.com



County of Galveston
10th District Court
Kerry L. Neves
Judge

660 18th St Suite 426
Galveston, Texas 77551

Office (409) 766-2036
Fax (409) 776-5288
kerry.neves@co.galveston.tx.us

2008 Marina Bay Drive, Suite 1
League City, TX 77573
281-532-0448
rvelliams@msmonkeyemperium.com
www.facebook.com/msmonkeyemperium
www.twitter.com/msmonkeyemperium
www.youtube.com/msmonkeyemperium
When it comes to solutions, we don't monkey around!
www.msmonkeyemperium.com



ROGER L. EKLUND
Residential Construction (Remodeling)
ROGER EKLUND
Owner
Estimates Available
Design & Construction
League City, Texas 77571
reklund@yaho.com
40+ Years Experience
Mobile (281) 543-2658

Welcome to
FUDDRUCKERS
Greatest HAMBURGERS

The Pet Rooster Band
Discipline with a few variations
Available for Your Next Event
• Banquet receptions
• Private parties
• Family reunions
• Church functions
• Monthly bluegrass jams
www.petroosterband.com • phone (979) 297-2709





PHOTOS from the Fire on the Strings Festival



Thanks to Travis Posey and Doc Henley for the great photos!

<http://baba123.smugmug.com/Other/2014-Fire-On-The-Strings/>

No WAY I can get all the photos on here... SEE THE WEBSITE! "LIKE" your favorites!



See the Spinney Brothers in Dallas - October 9



We are pleased to share a special evening with the internationally-acclaimed and award-winning [Spinney Brothers](#), and their full band, at the **University Park United Methodist Church!** According to Neil Rosenberg of Memorial University, "the heart of the Spinney Brothers' music lies in their duet singing that is as tight as you'll find in bluegrass today."

Our venue is the beautiful [Fellowship Hall of University Park United Methodist Church](#), located at **4024 Caruth Boulevard** in Dallas. This is just off Preston Road, about 1/4 mile south of Northwest Highway. The entrance to the hall is on Caruth across from Smith Park. Come early and jam in the park! Show begins at 7:30 p.m.



Stringing You Along

Dictionary for women

Argument (ar*gyou*ment) n. A discussion that occurs when you're right, but he just hasn't realized it yet.

Airhead (er*hed) n. What a woman intentionally becomes when pulled over by a policeman.

Bar-be-que (bar*bi*q) n. You bought the groceries, washed the lettuce, chopped the tomatoes, diced the onions, marinated the meat and cleaned everything up, but, he "made the dinner."

Blonde jokes (blond joks) n. Jokes that are short so men can understand them.

Cantaloupe (kant*e*lope) n. Gotta get married in a church.

Clothes dryer (kloze dri*yer) n. An appliance designed to eat socks.

Diet Soda (dy*it so*da) n. A drink you buy at a convenience store to go with a half pound bag of peanut M&Ms.

Eternity (e*ter*ni*tee) n. The last two minutes of a football game.

HEY MEMBERS!

Be sure to stop at the BABA table, and get a MEMBER door prize ticket.

We've give **two** great door prizes each month as part of your membership - no extra cost to you. Just get your ticket and cross your fingers!

THANKS!

P.S. You can join there, too.



Anton "Tony" Ullrich

is celebrating 42 years (1972 - 2014) of teaching folks in the greater Houston area to play Bluegrass style banjo.

Your private banjo lessons begin with an introduction to BanjerTab's unique approach to creating syncopation (that 'ahead of the beat' bounce) that you hear in the recordings of the first generation greats, who had no other form of learning than creating their banjo style 'as they went.'

Once you're familiar with BanjerTab, choose the area of playing you want to focus on: Scruggs style, full-chord back-up, mid-neck / high-neck picking, melodic style (fiddle tunes /back-up), or specific songs you have always wanted to play.

The expertise gained through 52 years of playing and 40 years of teaching is available to you now. Choose videotape lessons or come for private lessons in Houston.

Call 713-785-6655 or fax 713-532-6655



Authorized Deering Banjo Dealer
Home of the Texas Banjo

anton@banjerproductions.com
www.5stringbanjer.com

World Music
3750 Cartwright Rd.
281-403-1615

- We teach ALL INSTRUMENTS, including voice
- DVD Video & CD Audio Recording
- Instrument Sales
- Repair & Rental

GIFT certificates available

NA	FM 1092
	Cartwright
Hwy 6	

FREE MUSIC!
4th Saturday's
(January thru September)
Coushatte RV Ranch
Bellville, Texas
Buddy & Carolyn Brockett
(979) 877-9526
e-mail: bluegrass221@peoplepc.com
website: www.springcreekbluegrass.com



409-945-7446 or sales@tntsigns.net
2212 Palmer Hwy, Texas City, TX 77590



Professional Real Estate Inspectors

www.spacecityinspections.com

Ed Fryday

ASHI, TPREIA, TAREI, ICC, InterNACHI, HAR

281-636-9419



Colee and David Littlefield
Festival Management/Promoters
Salmon Lake Park

26717 Bayou Tesch Dr.
Magnolia, TX 77354

www.TXBluegrassMusic.com
coleebiller@aol.com

c. 936-697-5949
c. 281-259-5453

CLASS ACTS

**5-String Banjo Lessons
Beginner - Advanced**

**Guitar Lessons
Beginner - Intermediate**

Recording Studio

Does your child want to learn to play? Do YOU? Get started now, or improve your current skills.

You'll be glad you did!

KERRY JONES 833-545-7261

TALENT INDEX

Out of the Blue

Bluegrass, Gospel, & Western Swing
Lynn Holbrook 281-486-0657
lhollbroo@cisco.com

Before Electricity

Tom Roberts 713-863-7351

Brazos River Pickers

Anna Beavers 281-344-0601
anna@brazosriverpickers.com

Buffalo Nickel Bluegrass Band

Laney Sims 281-242-2383
lanesims@windstream.net

Cypress Creek

Jimmy Pike 713-202-9441
jlpik1@msn.com

Cypress Ramblers

Bill Sincler 713-481-1747
bill77429@comcast.net

Greer Family Band

Lawrence Greer 979-289-9936
lfgreer@juno.com
greerfamilyband.com

Greg English

830-387-9156
genglish43@gmail.com
<https://sites.google.com/site/gregenglish43/>

- "6 () * (- * ; " 3/4 4 5 3/4 (# " / %

Steve Bing 832-433-7914
stevebingmusic@aol.com
www.laughinglizardsband.com

LoneStar Bluegrass Band

Chris Hirsch 281-491-1680
chirsch@alltel.net
www.lonestarbluegrassband.com

Manchaca All Stars

Buck Buchanan 512-282-2756
Cara Cooke 512-280-9104
manchacaallstars@email.com

Pine Island Station

Gary Carter 936-520-2952
j9carter01@gmail.com
www.pineislandstation.com

Hallie Reeves

Solo Fiddle & Violin Performances
or with Accompaniment
713-477-2730
hallie.reeves@yahoo.com

Pet Rooster

Jay Richardson 979-297-2709
Jay@petrooster.com
www.petrooster.com

Shadetree Bluegrass Band

Ken MacDonnell 281-693-0391

Southern Style

Rick Kirkland 281-488-2244
crk5820@msn.com
Arvin Holland 713-305-5957
aholland@texasairservices.com

Texas Harmony

Becky Goodwin 281-787-1124
bluegrassbecky1@aol.com

The Bluegrass Solution

Richard Henry 713-937-4253
Michael Fuller 713-880-2188
mike@fullersguitar.com
www.thebluegrasssolution.com

White Dove

Glen Beaubouef 832-289-7895
texangie55@yahoo.com

Buddy & Tina Wright Group

Pat Wright
buddyandtina@earthlink.net
www.buddyandtina.com

Almost Heaven

Tony Redding 281-373-1777
Nema Redding 281-910-4395
tonynema@earthlink.net

Billy Bright & Geoff Union

Geoff Union 512-563-9821
geoffu@geoffunion.com

<http://geoffunion.com/brightunion>

A BIG BLUEGRASS THANKS!

to our members who help keep the music playing every month, and an extra shout out to those who have joined as Gold Club, Lifetime, Endowment and Foundation levels. We couldn't do this without all of you!

Members' names are in alphabetical order

Gold Club Members

Don & Jan Clark, Mike & Pat Conwell, Ed & Ann Fitchard, J.B. & Nancy Graham, Gerry & Kim Herman, Lynn Holbrook, Rick & Shirley Kirkland, Darryl & Tina O'Bryant, Laney & Shannon Sims

Membership in the Gold Club is payable annually. We thank you for your "extra" support.

BABA Lifetime Members: Brad & Dee Alford, Dave Aldrich, Scott & Diana Armstrong, Doris Arnett, Chris Bagley, Hubert & Shirley Brasseaux, Cara Cooke, Eric & Kim Corgey, Lyman & Annis Cox, Paul & Dana Cutts, Robert & Debi Duke, Bill & Joni Dusenbury, Harry Edwards, Ruth Evans, George Franklin, Jason & Alicia Fricke, Ed & Becky Fryday, Mike Fuller, Paul & Lillie Futch, John & Jean Gardner, Bill & Geri Gatlin, J.B. & Nancy Graham, Jim & Sharon Greenlee, Doris Grigg, Chuck & Mary Pat Gunn, Robert & Elizabeth Hasserd, Tom Harrison, Ron & Anne Hayden, Arvin & Sheryl Holland, Sammy & Oattie Holloway, Jan Johnston, Stan Jones, Paul & Linda Kerr, Pat Lomas, Ken & Wanda MacDonnell, Phil & Cecile Mathers, Paul & Madeline McKneely, Faber & Sandy McMullen, Patrick Milligan, Barbara Monroe, Charles & Ellen Orsburn, Mike Petitt, Bill & Glenna Pierpont, Norman Ponder, Billy Potts, Tony & Nema Redding, Karl Reid, Jack & Carol Ritter, Tom & Sandy Roberts, Jonathan & Kristine Samuell, Billy & Terry Schmidt, Jerry & Monica Scribner, Gordon Spaulding, O.K. & Sharon Stafford, Bob & Marilyn Taylor, James & Laura Taylor, Scott Teven, Charlene Threlkeld, David Towery, Helen Vinson, Viola Wakefield, Larry Wenner, Paul Williams.

Endowment Gift Members:

Phil & Fern Deans, Lisa Maranto

Foundation Member:

Ed Fryday

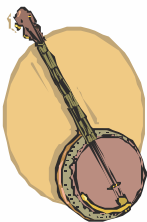

PICK YOUR NEWS

IBMA has announced plans for a streaming video broadcast of the 23rd annual show September 27 at 7:30 p.m. (CST) simultaneously on BluegrassNation.org and BluegrassToday.com, live from the historic stage of the Ryman Auditorium in Nashville, Tennessee.

The program will air once on both websites at no charge to viewers, but visitors to BluegrassNation.org will have the option to make a \$5-10 donation in a virtual PayPal tip jar to help cover expenses.

Co-sponsor Bluegrass Today is planning some pre-event programming at 6:45 p.m. (CST) with red-carpet video footage from the BMI Nominees Reception held earlier in the evening. The production team from Music City Roots will film the IBMA Awards for broadcast. The Nashville-based program streams live weekly on Wednesday nights at www.musiccityroots.com.

More about IBMA: All five Entertainer of the Year nominees – The Del McCoury Band, Balsam Range, The Gibson Brothers, Blue Highway, and Dailey & Vincent – as well as Awards Show hosts Lee Ann Womack and Jerry Douglas are among the confirmed performers. Special performances by The Seldom Scene and The Spinney Brothers will give tribute to this year's Hall of Fame Recipients.

A complete list of nominees, this year's Hall of Fame inductees, and the recipients of the Distinguished Achievement Award can be found at www.ibma.org.



Swap-n-Shop: a free service of the BABA newsletter - for musical instruments and items related to bluegrass music. Contact the editor @ bayareabluegrass2@aol.com

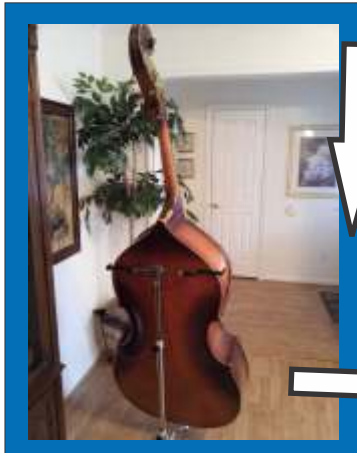

Wonderful, vintage (1940's) Kay Bass for sale. \$2,800
Contact Becky Goodwin, 787-1124 or email bluegrassbeckyl@aol.com

FOR SALE:
Dobro and Dulcimer
REDUCED: \$250 for the Dobro and \$100 for the Dulcimer....firm, final.
I don't know many details about either, so I wouldn't mind talking to someone about them.
Contact Pat - email patrh56@gmail.com or call 281-687-3554
Thanks!

CONGRATULATIONS ARE IN ORDER!!

See the flyer on page 6

Bloomin' Bluegrass nominated for IBMA Event of the Year!

~~~~~  
The FIFTH huge and FREE Bloomin' Bluegrass Festival and Chili Cook-Off music, jamming, and chili-eating weekend at the Farmers Branch Texas Historical Park is only seven weeks away - **Friday and Saturday Oct. 17-18!** This incredible weekend of music, JAMMING, and fun is **FREE** and perfect for the whole family - with no ticket required!

This festival is so much fun that it was nominated for the 2014 Bluegrass Event of the Year Award by the International Bluegrass Music Association!

# MORE SWAP 'N' SHOP

This is an excellent Bluegrass guitar! Bennie See email is:  
bsee1@comcast.net



Gibson J-60 1996 (Rosewood)  
Great Bluegrass Guitar  
Excellent Condition - \$1800  
bsee1@comcast.net  
Try Before You Buy in Houston

Announcing the Inaugural  
**Bob Wills**  
FIDDLE FESTIVAL & CONTEST  
Playin', Singin', &  
Western Swingin'  
in Downtown Greenville, Tx  
**OCTOBER 31 - NOVEMBER 2, 2014**  
Featuring Performances By  
**THE TIME JUMPERS** Featuring VINCE GILL, DAWN SEARS,  
KENNY SEARS AND RANGER DOUG GREEN AT THE GREENVILLE MUNICIPAL AUDITORIUM  
**THE JASON ROBERTS BAND & LEON RAUSCH**  
AT THE TEXAN THEATER  
Followed by a  
SATURDAY NIGHT DANCE Featuring  
**BOBBY FLORES** and the **YELLOW ROSE BAND**  
VISIT [BOBWILLSFIDDLEFEST.COM](http://BOBWILLSFIDDLEFEST.COM) FOR DETAILS  
AND [TWINFIDDLEPRODUCTIONS.COM](http://TWINFIDDLEPRODUCTIONS.COM) FOR CONTEST INFO  
FOLLOW US @BBERGVILLE

## About BABA

The Bay Area Bluegrass Association (BABA) was organized in 1986 and incorporated in 1987 under the Texas Non-Profit Corporation Act. The primary purpose of BABA is to preserve, encourage, and promote Bluegrass and Bluegrass gospel music as an American art form. BABA promotes Bluegrass through being active in community events, fund raisers, festivals, and monthly shows. BABA is a 501(c)(3) tax deductible organization; see any Director for information.

The monthly show is free to the public and features Bluegrass from the local and national scene. The stage show begins at 7:00 PM, but pickers are welcome to bring their instruments and come earlier to jam. Tasty, inexpensive food is available at the show, and there are raffles, door prizes, and Bluegrass merchandise for sale. This is a 'no alcohol' event, but there's plenty of music and great family fun!

Proceeds from donations, sponsors, memberships, sales, and raffles are used to keep the doors open and the regular shows free to the public. They also maintain and replace sound equipment, storage, security, and expense of keeping the music playing. We thank you for your attendance, your generosity, and your love of the music. 16



# MEMBERSHIP LEVELS

[JOIN: at the show, or online](#)

## **Individual Membership:** \$35.00 annually

You'll become a member of the BABA family and support the free monthly shows & jams. You'll receive the BABA Bulletin Newsletter monthly, admission to workshops at the monthly shows, admission to Bluegrass in the Park for BABA members & guest, updates about Bluegrass events in the area, discounts on some bluegrass shows in the area – as well as the satisfaction of supporting BABA and Bluegrass Music in Texas.

## **Family Membership:** \$50.00 annually

You'll become a member of the BABA family with all the benefits of the individual membership for you and your immediate family. You'll support the free monthly shows & jams, receive the BABA Bulletin Newsletter monthly, get admission to workshops at the monthly shows and admission to Bluegrass in the Park for BABA members & guest, get updates about Bluegrass events in the area, discounts on some bluegrass shows in the area - and the satisfaction of supporting BABA and Bluegrass Music in Texas.

## **Gold Club Membership Individual:** \$100.00 annually

Get all the benefits of the individual membership, a Gold Club Membership Name Badge, & a BABA shirt for giving that extra support to the BABA family. You'll become a member of the BABA family and support the free monthly shows & jams, receive the BABA Bulletin Newsletter monthly, get admission to workshops at the monthly shows, admission to Bluegrass in the Park for BABA members & guest, updates about Bluegrass events in the area, discounts on some bluegrass shows in the area - and the satisfaction of supporting BABA a little extra.

## **Lifetime Member Individual:** \$350.00

Get all the benefits of BABA membership for life! You'll become a member of the BABA family and support the free monthly shows & jams, and receive the BABA Bulletin Newsletter monthly. You'll get admission to workshops at the monthly shows, admission to Bluegrass in the Park for BABA members & guest, updates about Bluegrass events in the area, discounts on some bluegrass shows in the area - and the satisfaction of supporting BABA for life.

## **Lifetime Member Family:** \$500.00

Get all the benefits of BABA membership for life for you and your immediate family! You'll become a member of the BABA family and support the free monthly shows & jams, and receive the BABA Bulletin Newsletter monthly. You'll get admission to workshops at the monthly shows, admission to Bluegrass in the Park for BABA members & guest, updates about Bluegrass events in the area, discounts on some bluegrass shows in the area - and the satisfaction of supporting BABA for life.

## **Lifetime Gold Club Membership Individual:** \$1000.00

Get all the benefits of the individual membership, A Gold Club Membership Name Badge, A BABA shirt, and knowing that you are giving that extra support to the BABA family. You'll become a member of the BABA family and support the free monthly shows & jams. You'll receive the BABA Bulletin Newsletter monthly, admission to workshops at the monthly shows, admission to Bluegrass in the park for BABA members & guest, updates about Bluegrass events in the area, discounts on some bluegrass shows in the area -and the satisfaction of supporting BABA 'above and beyond'.

## Texas Bluegrass Jams & Shows

Combined list from **Bay Area Bluegrass Association** and **Central Texas Bluegrass Association** so wherever you are in Southeast to Central Texas, you might just as well bring your instruments because we're going to find you a place to pick and jam.

PLEASE notify us at [bayareabluegrass2@aol.com](mailto:bayareabluegrass2@aol.com) if you find any errors, or have a jam that you'd like changed, added or deleted. We list by day of the week, then by town/city.

### Mondays

**Bluntzer:** 3<sup>rd</sup> Monday, 2-6 PM, South Texas Bluegrass Gospel Jam, G&H BBQ, 5491 Hwy 624. phone 361-387-4552

Email [stx.bluegrass@gmail.com](mailto:stx.bluegrass@gmail.com),

**Cypress:** Every Monday 7-9:30 PM, St. Aidan's Episcopal Church, 13131 Fry Road. Email [tonynema@earthlink.net](mailto:tonynema@earthlink.net), phone 281-373-1777

**San Antonio:** 2<sup>nd</sup> & 4<sup>th</sup> Mondays, 7 PM, "Monday-in-a-Jam" at Grady's BBQ, 327 E. Kakoma Dr., 78216. Phone Peyton Starr 210-870-4321 or Sheryl Sultenfuss (no phone listed)

### Tuesdays

**Llano:** 1<sup>st</sup> & 3<sup>rd</sup> Tuesday, 7 PM, Beginner/Intermediate, 1<sup>st</sup> Presbyterian Church. Phone Jeff White 325-248-4114

**Medina:** 2<sup>nd</sup> Tuesday, All Gospel Jam, 6 PM, 1<sup>st</sup> Baptist Church. Phone Linda Barton, 830-589-2486

**Nassau Bay:** 1<sup>st</sup> Tuesday, 7-@9 PM at Fuddrucker's, 2040 NASA Pkwy, 281-933-1620

**Shulenburg:** 1<sup>st</sup> & 3<sup>rd</sup> Tuesday, 6:30-9:30, Shulenburg RV Park Clubhouse. Phone Loretta Baumgarten 979-743-4388 or Email [camp@ShulenburgRVPark.com](mailto:camp@ShulenburgRVPark.com)

### Wednesdays

**Austin:** 1<sup>st</sup> Wednesday, 7-10 PM, Musician's Woodshed, 3698 RR 620 South, Ste. 107, 78738, [themusicianswoodshed.com](http://themusicianswoodshed.com)

**Houston:** each Wednesday, 6-9 PM, at Hickory Hollow, 100 Heights Blvd, Houston (just south of I 10 on Heights Blvd)

### Thursdays

**Austin:** 1<sup>st</sup> & 3<sup>rd</sup> Thursdays, 7 PM, Bruce Manbridge's home. **Contact Steve Mangold for all Austin Jam info, 512-345-6155**

**Georgetown:** Every Thursday, 5:30-7:30 PM, Duke's BBQ. Email [sigi@sigi.us](mailto:sigi@sigi.us), phone 512-869-8076

**Groves:** Every Thursday, 7 PM, Allie Morvent's House, phone 409-962-5236

**Manchaca:** Every Thursday, 6:30-9 PM, Manchaca Railroad BBQ, FM 1626. Phone Dave 512-680-4433

### Fridays

**Bandera:** 4<sup>th</sup> Friday, 6:30 PM, Silver Sage Corral, east of Bandera. For info, phone 830-796-4969

**Carthage:** 1<sup>st</sup> Friday, 6:30 PM, Town Square. For info, phone 903-678-3857

**Dickinson:** Every Friday, 7-9 PM, Dickinson BBQ, 2111 FM 517 E. Phone 281-534-2500

**Hondo:** 1<sup>st</sup> Friday, begins 11 AM, Hondo Hootenany. Hondo Community Center, 1014 18<sup>th</sup> St. Phone 830-426-2831

**Manchaca:** Every Friday, 7 PM show, Fire Hall, FM 1626 (1 mile West of Manchaca Rd.) Phone 512-282-3600

**Utopia:** 3<sup>rd</sup> Friday, 7 PM, Senior Citizen's Center. Phone Skip Doerr 830-966-6362

**Victoria:** 3<sup>rd</sup> Friday, Slow Jam 5-7 PM, regular jam 7-10 PM, American Legion Post #166, 1402 E. Santa Rosa. Free Admission. Email [crossroadsbluegrass@yahoo.com](mailto:crossroadsbluegrass@yahoo.com) or phone Stan Kendrick 361-935-4413 or Gary Moses 361-550-5466

### Saturdays

**Alvin:** Every Saturday, Texas Opry, no time given, 1720 Sealy, Admission is charged. Phone 281-432-2942

**Austin:** 2<sup>nd</sup> & 4<sup>th</sup> Saturdays, slow jam 2-4 PM, intermediate 4-6 PM, CTBA sponsored. 3801 Berkman Dr., 78723.

**Beaumont:** 4<sup>th</sup> Saturday, no time listed, Rosedale Baptist Church, 7110 Concord. S.E. Texas Dulcimer Friends. Phone 409-866-0848

**Bellville:** 4<sup>th</sup> Saturday, 4 PM jam & 6 PM show Jan through Sept, Coushatta RV Ranch, Spring Creek Bluegrass Club.

Email [bluegrass221@peoplepc.com](mailto:bluegrass221@peoplepc.com), phone 979-865-5250, website [www.springcreekbluegrass.com](http://www.springcreekbluegrass.com)

**Carrollton:** Every Saturday March - Nov, 7:30 PM - 1 AM, between Main & State Sts. @ 6<sup>th</sup> St.

Phone Jim Miller 972-279-3197 or website [www.meetup.com/bluegrass-142](http://www.meetup.com/bluegrass-142)

**Cypress/Tomball:** 4<sup>th</sup> Saturday, noon - 4PM, Kleb Woods Nature Center, Muschke & Draper Rds.

Email [tonynema@earthlink.net](mailto:tonynema@earthlink.net) or phone 281-373-1777 or 281-910-4396.

**Deer Park:** 2<sup>nd</sup> Saturday, 11 AM-3 PM, Troy's Music Shop, 4005 Center St. No contact listed.

**Fayetteville:** 2<sup>nd</sup> Saturday, 6 PM April - Nov, Courthouse Square. Email [info@texaspickinpark.com](mailto:info@texaspickinpark.com) or website [www.texaspickinpark.com](http://www.texaspickinpark.com)

DON'T STOP NOW, WE'RE JUST GETTING STARTED! CONTINUED ON NEXT PAGE.....



here's the rest of the jam and show schedule! 'pick' your favorite.....

### **Saturdays continued**

**Field Creek:** 1<sup>st</sup> Saturday, 6 PM, Field Creek Music. Field Creek is between Llano and Brady on Hwy 71.

Phone Bill Tuckness 325-247-3223

**Glen Rose:** 3<sup>rd</sup> Saturday, no time listed, Oakdale Park, Paluxy River Bluegrass Assoc., free stage show, camping encouraged.

Phone John Scott 817-525-0558

**Harwood:** 3<sup>rd</sup> Saturday, 2 -9 PM, Jam & Stage Show. 9 mi. E. of Luling, Hwy 90. Phone Tony Conyers 512-601-1510 or 512-940-3731

**Henderson:** 1<sup>st</sup> Saturday, 6 PM, Odd Fellows Hall. Phone 903-889-2783 or 903-566-6650

**Houston:** 2<sup>nd</sup> Saturday, 7:30 PM, Admission charged and not always bluegrass, Houston Folklore Society, West University Community Building, 6104 Auden. Phone 281-347-3235

3<sup>rd</sup> Saturday, 3-6 PM, Woodland Christian Church, 607 Rogers, North Harris County Dulcimer Society. No phone listed.

**Huntington:** Nothing going on any more. Find a new jam? email the editor at [bayareabluegrass2@aol.com](mailto:bayareabluegrass2@aol.com)

**League City:** 3<sup>rd</sup> Saturday, 5-11 PM jam, 7 PM show, 300 W. Walker St @ the Civic Center, Bay Area Bluegrass Assoc. Phone 281-488-2244

**Liberty Hill:** 4<sup>th</sup> Saturday, 1-6 PM, Hwy 29 West. Phone Paula 512-778-5410

**Llano:** 1<sup>st</sup> Saturday, 6 PM, Field Creek Music. Field Creek is between Llano and Brady on Hwy 71.

Phone Bill Tuckness 325-247-3223

4<sup>th</sup> Saturday Jan – Oct, 5:30 – 10:30 PM, Bluegrass in the Hill Country Jam, The Badu House.

Email [info@bluegrassinthehillcountry.org](mailto:info@bluegrassinthehillcountry.org)

**Marshall:** 3<sup>rd</sup> Saturday, 7 PM Show, Lions Community Center, 1201 Louisiana St. Phone 903-935-7023

**Minden:** 3<sup>rd</sup> Saturday, 5:30 PM, Community Center. Phone 903-657-3320

**Montgomery:** 1<sup>st</sup> Saturday, 10 AM-2 PM, Downtown historical District. Discount coupons at local KOA.

Email [mld@consolidated.net](mailto:mld@consolidated.net) or phone 936-597-5002

**Needville:** 1<sup>st</sup> Saturday, 6 PM-8 PM concert. Brazos River Pickers perform free at Brazos Bend State Park in the amphitheater. Concert is free but usual State Park Entry fees apply. Phone 281-344-0601 or

website [www.brazosriverpickers.com](http://www.brazosriverpickers.com)

**Odessa:** 2<sup>nd</sup> Saturday, Noon to 6 PM, Jam and potluck dinner for pickers and for grinners (guests welcome): Acoustic only with exception for bass; Music is Bluegrass, Old Time Country, Gospel and 'other'. No smoking or alcohol. 4400 Andrews Highway @ Jesus Connection Church, Odessa Contact Pete & Claudette Stull, ph: 432-362-6944,

email: [wb7amp@cablone.net](mailto:wb7amp@cablone.net)

**Pearl:** 1<sup>st</sup> Saturday, 1 PM, Pearl Bluegrass Jam & Show. Old School House on FM 183 (not US 183). 7 mi. South of

**Purmela.** RV hookups available. Phone Ronald Medart 254-865-6013 or website [www.pearlbluegrass.com](http://www.pearlbluegrass.com)

**Round Rock:** 3<sup>rd</sup> Saturday, 2-5 PM, Danny Ray's Music, 12 Chisholm Trail. Phone 512-671-8663 or

website <http://dannyraysmusic.com>

**Sacul:** 4<sup>th</sup> Saturday, 6:30 PM, Opry House, Hwy 204 (25 mi. SE of Jacksonville). Phone 903-586-8484 or 409-326-4544

**Sulphur Springs:** 3<sup>rd</sup> Saturday, October through March. No time listed. 400 Como St. Phone 903-885-4078 or 903-885-7063

**Tomball:** 2<sup>nd</sup> Saturday, 4PM jam & 6 PM show, Oklahoma Community Ctr., Conroe-Huffsmith Rd. off FM 2978.

Phone 281-850-1413

**Walker, LOUISIANA:** in case you sneak across the border. 4<sup>th</sup> Saturday, no time listed, Old South Jamboree, U.S. Hwy 190.

Phone 504-664-3630

**Wrightright:** 4<sup>th</sup> Saturday, 7 PM, Opry House. Phone 903-364-2539

### **Sundays**

**Austin:** every Sunday, 2 PM, Scholz Garten, 1607 San Jacinto, 78701

**Corpus Christi:** 2<sup>nd</sup> Sunday, 2 PM, Heritage Park. South Texas Bluegrass Association, Phone Bill Davis 361-387-4552

**Grapevine:** 3<sup>rd</sup> Sunday, noon to 6 PM, Holy Trinity School, 3750 William D. Tate Ave. Phone 214-542-4402

OK, folks, that's what we have in our combined list. Remember, that old saying is still true:

**“garbage in, garbage out”**

so if you know of any changes, corrections, deletions or updates, PLEASE notify us at

[bayareabluegrass2@aol.com](mailto:bayareabluegrass2@aol.com)

so we can keep the information current and correct. always call before traveling,

just in case!





**PRESIDENT**

Rick Kirkland

**VICE-PRESIDENT**

Laney Sims

**TREASURER**

Chris Bagley

**SECRETARY**

Judy Sturgeon

**DIRECTORS**

Phil Deans

Travis Posey

Ron Hayden

Arvin Holland

Darryl O'Bryant

Lynn Holbrook

Anne Hayden

Roger Ecklund

**WEBMASTER**

Travis Posey

tposey123@yahoo.com

**EDITOR**

bayareabluegrass2@aol.com

**BABA INFO**

281-488-2244

**TO ALL FUDDRUCKER'S JAMMERS:**

If you like the Fudd's jams but haven't been getting your monthly email reminder, shoot us an email request at: bayareabluegrass2@aol.com. If you'd like to be added to the list, just let us know!

**Join us at Fuddrucker's, NASA Parkway, on the FIRST TUESDAY of every month for dinner and jamming. Turn in a BABA 'coupon' and we will receive a percentage of your food and drink purchase price as a donation from Fudd's. Great food, great friends, great bluegrass....how good can it get?! See Rick Kirkland for a coupon at the Jam.**

**BLUEGRASS RADIO WAVES & INTERNET SITES**

**KNES - FM 99.1 SUN 2-5 PM** Fairfield, Carl Conkling

**KEOS - FM 89.1 TUES 7-9 PM** College Station, John Roths

**KPFT - FM 90.1 SUN 4-6 PM** Houston, Chris Hirsch

**KVLU - FM 91.3 SAT 7-9 PM** Beaumont

**KOOP - FM 91.7 SUN 10 AM-NOON** Austin, Sharon Sandormirsky/  
Ted Branson/ Rod Moog

**KKUS - FM104.1 9-10 AM** Tyler, Dave Rousseau

**KSHN - FM 99.9 SAT 8:30-10:30 PM** Liberty, Roy Bennett

**KSYM - FM 90.1 SUN NOON-2 PM** San Antonio, Hank Harrison

**KJIC - FM 90.5 SAT & SUN 6 AM-6 PM** Houston, Believers Bluegrass

**KAMU - FM 90.9 SAT 7-8 PM** College Station, Dave Higgs (Nashville)

[www.bayareabluegrass.org](http://www.bayareabluegrass.org)

[www.bluegrassdog.com](http://www.bluegrassdog.com)

[www.bluegrassheritageradio.com](http://www.bluegrassheritageradio.com)

[www.bluegrassmusicjams.com/jam-texas.html](http://www.bluegrassmusicjams.com/jam-texas.html)

[www.centraltexasbluegrass.org](http://www.centraltexasbluegrass.org)

[www.cybergrass.com](http://www.cybergrass.com)

[http://ibma.org](http://http://ibma.org)

[www.southwestbluegrassclub.org](http://www.southwestbluegrassclub.org)

[www.spbgma.com](http://www.spbgma.com)

[www.texasbluegrassassociation.com](http://www.texasbluegrassassociation.com)

[www.westtexasbluegrasstraditionalmusicassociation.com](http://www.westtexasbluegrasstraditionalmusicassociation.com)



The BABA Bulletin would like feedback and Bluegrass articles from our readers. Tidbits or articles can be: an amusing quote; reviews of festivals or music conventions; behind-the-scenes reports of bands; technical; RV and campground reviews; anything that you feel would be of interest to Bluegrass enthusiasts. Articles can span more than one issue, and full credit will be given. Original, uncopyrighted work only, please and thank you!

A minister waited in line to have his car filled with gas just before a long holiday weekend. The attendant worked quickly, but there were many cars ahead of him. Finally, the attendant motioned him toward a vacant pump.

"Reverend," said the young man, "I'm so sorry about the delay. It seems as if everyone waits until the last minute to get ready for a long trip."

The minister chuckled, "I know what you mean. It's the same in my business."

While driving in Pennsylvania , a family caught up to an Amish carriage. The owner of the carriage obviously had a sense of humor, because attached to the back of the carriage was a hand printed sign... "Energy efficient vehicle: Runs on oats and grass. Caution: Do not step in exhaust."

There is the story of a pastor who got up one Sunday and announced to his congregation: "I have good news and bad news. The good news is, we have enough money to pay for our new building program. The bad news is, it's still out there in your pockets."

How come we choose from just two people to run for president, and over fifty for Miss America?

I signed up for an exercise class and was told to wear loose fitting clothing. If I HAD any loose fitting clothing, I wouldn't have had to sign up in the first place.

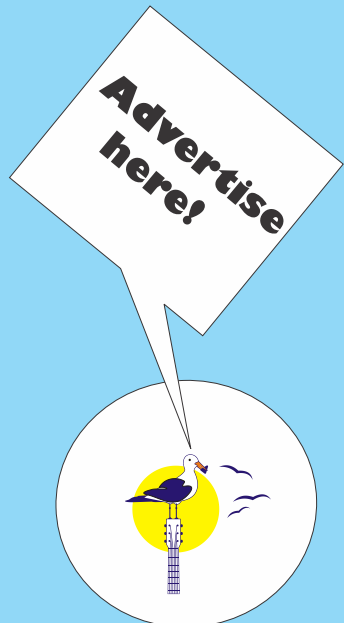

<http://ibma.org/membership>

Support your local bluegrass music association. Memberships for adults start at \$40 dollars and the professional single membership is \$75.

**ADVERTISING RATES**

**Business Cards**

**\$50 per year**

**\$5 per issue**

**Quarter Page**

**\$75 per year**

**\$10 per issue**

**Half Page**

**\$150 per year**

**\$15 per issue**

**Full Page**

**\$300 per year**

**\$30 per issue**

email for information:

[bayareabluegrass2@aol.com](mailto:bayareabluegrass2@aol.com)



*Bay Area Bluegrass Association*

